

BONALDO

Botón



The name - "button" in Spanish - refers to the metal inserts applied to the base, which catch the attention due to the contrast they make with the table's overall image. The material of choice for Botón is fused tempered glass, a choice that accentuates the product's elegance and sophistication and which makes it the

perfect piece to place in the centre of a space as the undisputed star of the dining room. The rounded rectangular top of the Botón table has a linear design, while each of the two legs that form the base is made of a pair of glass strips that extend outwards, forming an angle that gives the table stability.



Data sheet

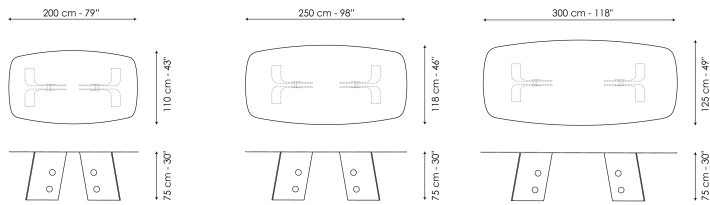

Width: 200cm
Depth: 110cm
Height: 75cm

Width: 250cm
Depth: 118cm
Height: 75cm

Width: 300cm
Depth: 125cm
Height: 75cm

Top and Base

Glass



Tempered cast glass
Smoked

Base inserts

Plus Metal



Painted metal
Mat lead

The samples above represent the complete range of materials and finishes available for this product (regardless of the top shape or size, in the case of tables). Fabrics, eco-leather, leather and emery leather shown in this website are a selection. Colors and finishes are approximate and may slightly differ from actual ones. Please visit Bonaldo dealers to see the complete sample collection and get further details about our products.